

ON THE DRAWING BOARD

In the words of pioneering architect Jean Nouvel, “Each new situation requires a new architecture.” What’s coming up next for Hawai‘i?



HOTEL RENEW

Opening this summer, Hotel Renew is being billed as O‘ahu’s first “design boutique” hotel. The 70-room is definitely a departure from Waikīkī’s ubiquitous Island aesthetic, featuring an elegant monochromatic color scheme with clean lines and dark woods. Designer Jiun Ho says, “We’re trying to create a tranquil environment. We wanted to use primitive, organic materials that would convey the Island feel in an understated way.” Tech-savvy visitors haven’t been forgotten—each room features high-tech amenities such as computerized multimedia systems and televisions that project directly onto the wall.

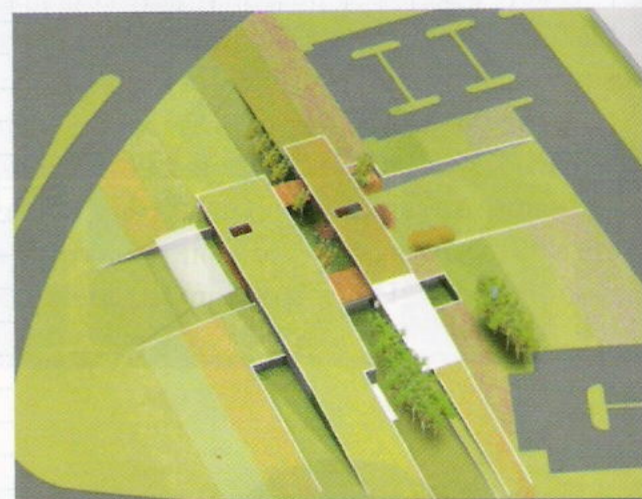

THE MĀLAMA LEARNING CENTER

More than three years after winning the contract to design an environmentally friendly learning center for Kapolei High School and The Nature Conservancy, architectural firm Eight Inc. is now working to streamline its plan, after inflation made construction costs jump 40 percent. There’s still room for amenities, including an outdoor performance space modeled on the form of the traditional hula mound.